

11R Pilot Controlled Regulator – Compact

- Balanced poppet provides quick response and accurate pressure regulation
- Pilot controlled regulators can be mounted “out of reach” with pilot regulator installed in a convenient location
- Solid control piston for extended life
- Two full flow 1/4" gauge ports can be used as additional outlets
- Pilot port 1/4 Inch
- 1/4", 3/8", 1/2" ports (NPT, BSPP)

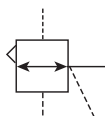

Port Size	Description	Part Number
1/4"	Without Gauge	11R115PC
1/4"	With 160 psi Gauge	11R121PC
3/8"	Without Gauge	11R215PC
3/8"	With 160 psi Gauge	11R221PC
1/2"	Without Gauge	11R315PC
1/2"	With 160 psi Gauge	11R321PC

NOTE: 2.0 Dia. (51 mm) hole required for panel mounting.

Operating information

Supply pressure (max):	0 to 250 psig (0 to 17.2 bar)
Operating temperature:	32°F to 175°F (0°C to 80°C)
Flow capacity†:	
High flow	1/4" 85 scfm (40 dm³/s, ANR)
	3/8" 95 scfm (44.8 dm³/s, ANR)
	1/2" 95 scfm (44.8 dm³/s, ANR)
Gauge ports (2):	1/4 inch (can be used as additional full flow 1/4 inch outlet ports)
Weight:	1.3 lb (0.53 kg)

† scfm = Standard cubic feet per minute at 100 psig inlet, 90 psig no flow secondary setting and 10 psig pressure drop.

Ordering Information:

11R	2	15	P	C	
Port Threads					Port Type
1/4 inch	1				Blank NPT
3/8 inch	2				1 BSPP
1/2 inch	3				
Relief / Gauge Options				Engineering Level	
Without gauge				C Current	
Non-relieving piston	14				
Relieving piston	15				
With gauge *				Adjustment	
Non-relieving piston	19			P Pilot Operated	
Relieving piston	21				

* Includes 2" dial face gauge 0 to 300 psig.

 Most popular.



For inventory, lead times, and kit

K50

Parker Hannifin Corporation
Pneumatic Division

Compact Pilot Controlled Regulators

Material Specifications

Body & pilot cap	Zinc
Piston, valve poppet, & collar	Plastic
Seals	Nitrile
Springs	Steel

Repair and Service Kits

Seat Insert kit	PS713P
2" dial face 60 psig (0 to 4.1 bar), gauge	K4520N14060
2" dial face 160 psig (0 to 11.0 bar), gauge	K4520N14160
2" dial face 300 psig (0 to 20.7 bar), gauge	K4520N14300
1-3/4" digital round face 160 psig (0 to 11.0 bar), gauge	K4517N14160D
Mounting bracket kit (includes panel mount nut)	PS707P
Panel mount nut, plastic	P04082
Panel mount nut, metal	P04079B
Pilot conversion kit – relieving	PS745P
Non-Relieving	PS747P
Relieving	PS749P

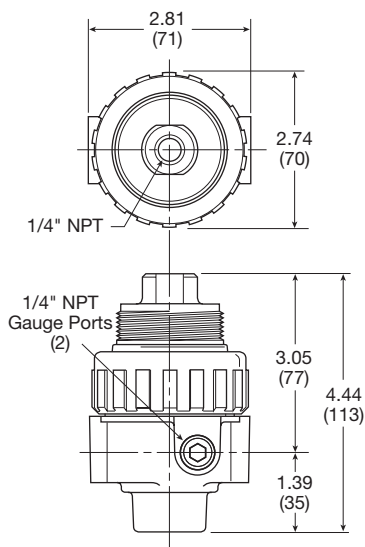

Inches (mm)

Regulator Products

Flow Charts

1/2" Regulator

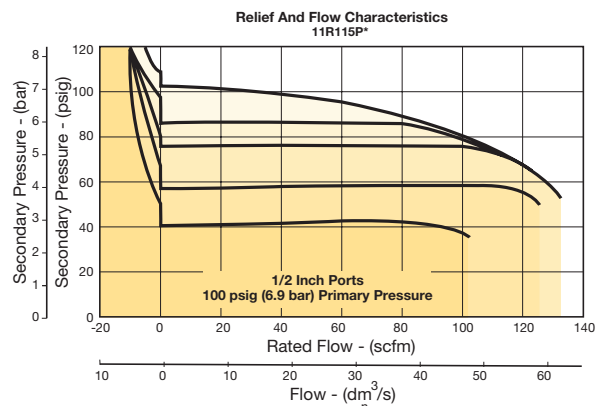

3/8" Regulator

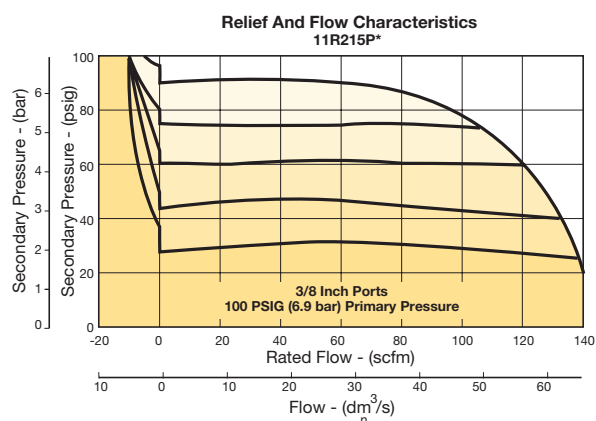

WARNING

Product rupture can cause serious injury.
Do not connect regulator to bottled gas.
Do not exceed Maximum primary pressure rating.

General

Dial

Pilot

Proportional

Precision

Water

K
Regulator
Products



For inventory, lead times, and kit

K51

Parker Hannifin Corporation
Pneumatic Division